



# BRETTALES

4 Old Orchard | Layham | Suffolk



Chapman Stickels

# BRETТАLES, 4 OLD ORCHARD, UPPER STREET, LAYHAM, SUFFOLK, IP7 5LB

A SPACIOUS DETACHED BUNGALOW WITH STUNNING FAR  
REACHING VIEWS OVER THE RIVER BRETT AND BEYOND

Hadleigh - 1.8 miles

A12 - 3.5 miles

Ipswich - 10 miles

- 
- Reception hall • Sitting room • Dining room • Kitchen/breakfast room •
  - 3 double bedrooms (one en suite) • Bathroom • Single garage • Raised deck •
  - Split level gardens of about 0.23 acres •





### The Property

Brettales is a spacious detached bungalow set on a cul-de-sac with quite stunning far reaching views across the River Brett and farmland beyond.

The principal rooms are positioned to take advantage of the scenery, the open plan layout comprises: sitting room with wall mounted gas fire which opens into a kitchen/breakfast room with a casement door out to a raised deck.

The kitchen has extensive worksurfaces together with built in dishwasher, oven and ceramic hob, and fridge. There is also a separate dining room, 3 double bedrooms, one with an en suite shower room, and a separate bathroom.



### Outside

Brettales is set well back from the road behind an established beech hedge with ample parking and a single garage.

The split-level rear garden is a particular feature leading down to the River Brett, the plot in total is about 0.23 acres.

There is a large storage area underneath the bungalow which is reached from the garden.

### Location

Brettales is located 1.8 miles from the popular historic market town of Haverhill which is situated about 9 miles from Ipswich, 9 miles from Manningtree and about 14 miles from Colchester – all having main line services for London's Liverpool Street station. The bustling town centre offers a wide range of local amenities including restaurants, pubs, sports facilities and a wide selection of shops.

### Services

Mains electricity, water, and drainage. Oil fired central heating, bottle gas for the fire.

### Local Authority and Council Tax Band

Babergh with Mid Suffolk District Council  
Band D



# 4 Old Orchard, Layham, IP7 5LB

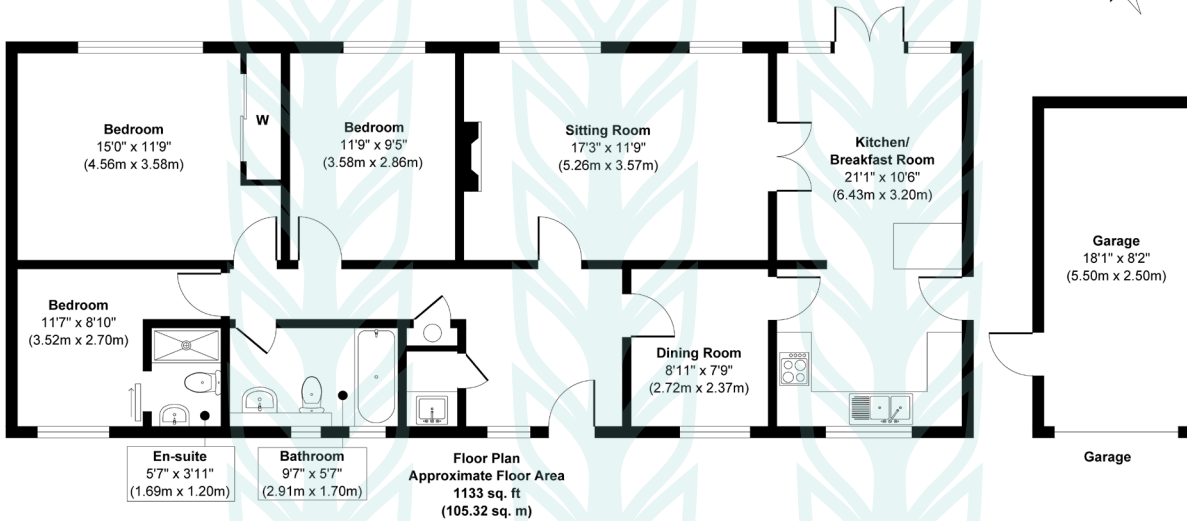

**Approx. Gross Internal Floor Area 1133 sq. ft / 105.32 sq. m**  
Illustration for identification purposes only, measurements are approximate, not to scale.

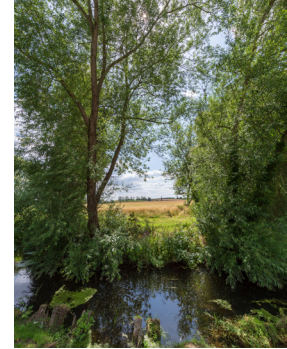

## Chapman Sticksels

The Corn Exchange,  
Market Place,  
Hadleigh,  
Suffolk,  
IP7 5DN

info@chapmansticksels.co.uk  
www.chapmansticksels.co.uk

01473 372 372

## All enquiries:

**Benedict Sticksels**  
ben@chapmansticksels.co.uk

**Robert Chapman**  
robert@chapmansticksels.co.uk



Scan the QR code to visit our website



rightmove

PrimeLocation.com

onTheMarket.com

Zoopla



**IMPORTANT NOTICE**  
Chapman Sticksels states these particulars are for general information only and do not constitute an offer or contract or part thereof. All descriptions, photographs and plans are for guidance only and should not be relied upon as statements or representations of fact. All measurements are approximate where stated. Any prospective purchaser must satisfy themselves of the accuracy of the information within these particulars by inspection or otherwise. Chapman Sticksels does not have any authority to give any representations or warranties whatsoever in relation to this property (including but not limited to planning/building restrictions), nor can it enter into any contract on behalf of the client. We do not accept responsibility for any expenses incurred by prospective purchasers in inspecting properties which have been sold, let or withdrawn. If there is anything of particular importance to you, please contact us where we will endeavour to have any information or queries checked.